



P.O. BOX 2, DISLEY, CHESHIRE, SK12 2NN, ENGLAND. Tel: DISLEY ~~(01663 762187)~~ (01663 762187)
Suppliers of Machinery for Mitreing Wood and Metal and Underpinners for the Picture Frame Industry

OPERATING INSTRUCTIONS FOR 78 - OR - 100 WARNING. THE BLADES ARE VERY SHARP, TAKE CARE AT ALL TIMES As soon as you have unpacked the machine fit the Perspex guards supplied.

Setting Up

As the machine is set and greased at the factory you only need to insert the handle into casting No. 5 and lock it in with the allen screw. Do not over tighten the screw. Now the handle is fitted release the bolt No. 14 in the back of the machine and the 78 or 100 is ready for use.

Initially the machine may seem stiff but this will soon wear off.

Length Stop Assembly

This is supplied with the machine and can be fitted and locked into the rear lower edge of the table on the left or right hand side to suit the operator. The assembly is telescopic and will extend to 40".

Capacity

As a trimmer wood up to appx 4" x 2" flat and 6" x 1" on edge can be trimmed to any angle between 45° and 90°. The machine will also cut two mitres (only 45°) in the middle of a length of wood by progressively nibbling through from the back. If too much pressure is used it may slightly tear the fibres of the wood but a further fine cut will give a perfect cut.

Use and Adjustment of Rebate Supports (Optional extra)

Rebate supports are only used for mouldings with rebates: for any other work they can be removed completely, provided the cutterblock is moved to its furthest position, i.e. giving maximum throat clearance.

The rebate support is moved into the rebate whilst the moulding is firmly held against both table and fence. In that position the support is adjusted to the full height of the rebate without moving the moulding off the table. Next, turn the locking screw to ensure that the rebate support remains firmly fixed.

For any of the above adjustments the knives should be moved back to their furthest position to prevent possible injury.

Operating the Machine

Move the hand wheel clockwise: the knives are now in their foremost position and the knife block should be in its topmost position.

Place the moulding on the tabletop and hold against the fence.

If it is a rebated moulding adjust the rebate supports as described.

Move the knife block back by means of the black hand wheel. The amount will depend on the height and width of the moulding. With a 60mm wide moulding the knife block should be moved approximately 40 mm back.

Next, depress the handle fully to cut, lift your hand and allow the knife block to return to its position. Move the hand wheel one or two turns clockwise and repeat the cutting action until the moulding is completely severed.

The last cut should be only half that of its preceding ones. This last cut gives a planed finish to the cut. Operators should observe the advantage of this fine cut even with small-section mouldings which might easily be cut with a single cut.

Changing of Knives

Be very careful, even blades you think need sharpening can still give you a nasty cut. Push the handle up and using the box spanner provided tighten the bolt No. 14 in the back of the machine to lock the cutterblock in the up position. Using the box spanner remove the bolts in the left hand blade. Carefully remove the blade, replace it with the new one and insert the bolts. Tighten the bolts whilst pressing the blade against the right hand one. Repeat with the right hand blade always making sure the blades are level at their lowest point.

The knives and the knife block must be absolutely free from any kind of dust, for even the smallest amount of dust will prevent proper alignment and result in the knives being incorrectly adjusted in relation to the bottom knives.

Cutting of Mitres other than 45 Degrees

If, for instance, a six-sided frame is to be made then the following method is used:

Six mouldings are cut in the normal manner with angles of 45 degrees each. However, each side is made slightly larger than the intended final size.

Each fence is then set at 60 degrees and the ends are recut individually at 60 degrees.

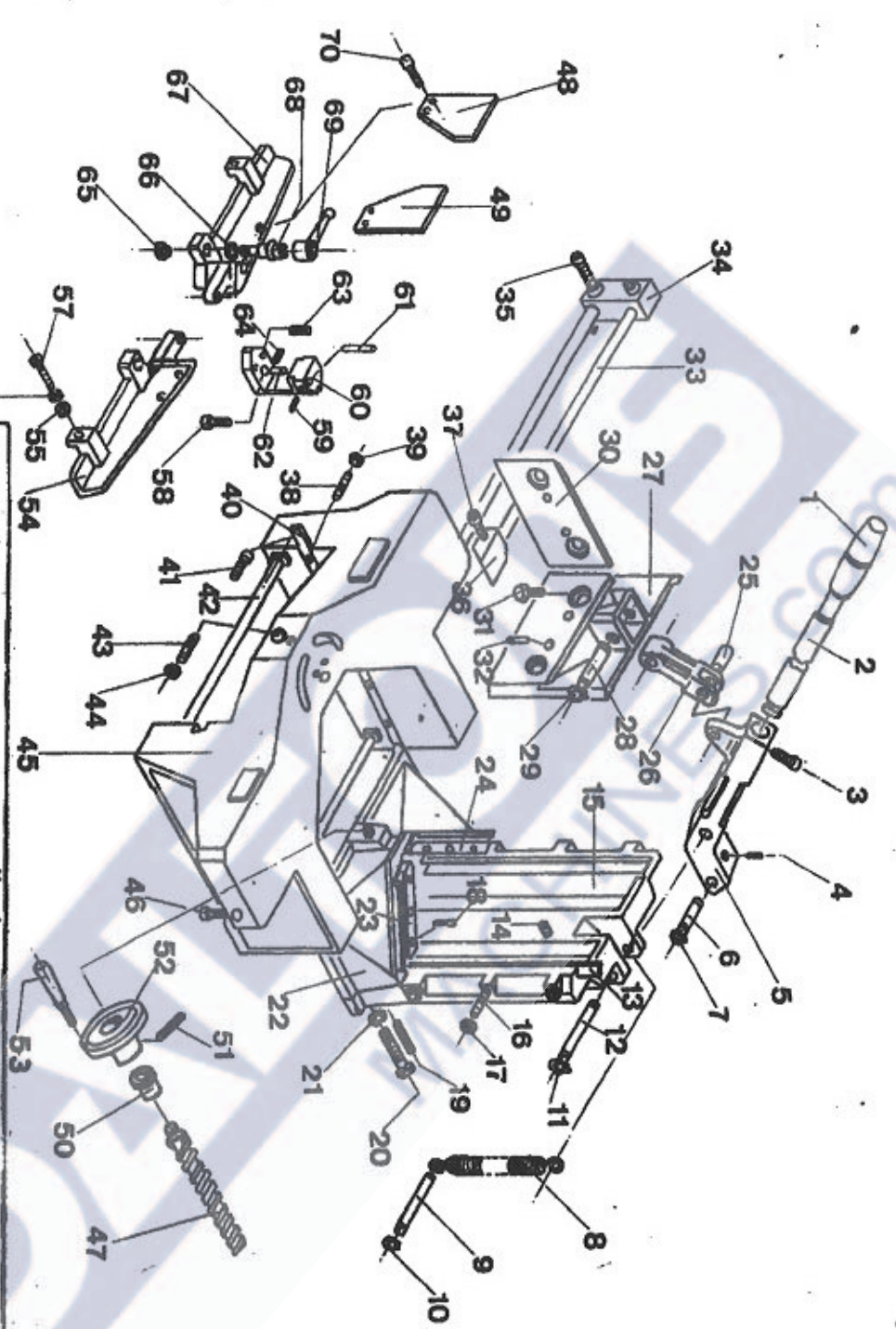

CONSTRUCCIONES MECANICAS

ortegui

Lista de repuestos Casilla Inyectora Mod. 78-98-C-180.
 Lista de pièces détachées Casilla Corps à angle Modèle 78-C-181
 Spare-parts List-Mitre-Cutting Machine Type 78-98-C-180.
 Ersatzteile-Gehänge Wskel-Schneemaschine Typ78-98-C-180